



**Government of Pakistan  
PAKISTAN ORDNANCE FACTORIES  
TENDER ENQUIRY**

To

M/s \_\_\_\_\_  
\_\_\_\_\_  
\_\_\_\_\_

Dear Sirs,

Reference : TENDER ENQUIRY NO. 0005/FP/54/Capital Pur-MGFy DATED 27-Feb-25

You are requested to submit quotations for the items noted in the schedule to the tender. Offers should be sent duly sealed in an envelope. Please note the following instructions for filling the tender:-

**1. SUBMISSION OF TENDER**

- 1.1 Tenders will be opened at 1100 hrs on **11-April-25** at Bidding Centre adjacent to Rabita Hall, POF Wah Cantt. and must reach at Bidding Centre before 30 Minutes of opening time. The tender received late will not be entertained. You may witness the opening of the tender if you so desire. If a representative is deputed, he should bring a letter of authority from you.
- 1.2 Only one tender should be included in one envelope. The outside of the envelope should be inscribed with:-

Tender Enquiry No: 0005/FP/54/Capital Pur-MGFy  
Tender to be opened on: 11-April-25  
Address as follows:-

MANAGING DIRECTOR  
MACHINE GUN FACTORY POF WAH CANTT  
AT BIDDING CENTRE (RABTA HALL) POF WAH CANTT

- 1.3 If envelope does not indicate reference of T.E. or received late the same may be returned un-opened.
- 1.4 Tender "By Hand" can be delivered at Bid Center, Rabita Hall, POF Wah Cantt.

**2. GENERAL INSTRUCTIONS REGARDING PREPARATION OF QUOTATIONS**

- 2.1 For materials, the prices should be filled in column 5 and delivery date in column 6 of the schedule to this Tender Enquiry. The undertaking should be signed at the bottom of the Schedule which shall form the Quotation. You may use a separate sheet if necessary.

- 2.2 The tendering procedure as laid down in PPRA Rule No. 36 d i.e Two stage Two envelope will be applicable. For Plant and Machinery, you are required to quote in two parts:-

**Part I "Technical Offer":** It should exclusively give technical details and literatures/ brochures of the offered plant, machinery and equipment; validity date; delivery schedule; and signed undertaking given on the schedule to this Tender Enquiry. It must not indicate price, costs etc.

**Part II "Commercial Offer":** It should indicate the commercial terms e.g. price, terms of payment, mode of payment, mode of supply.

Each part should be placed in a separate sealed cover. The envelopes should be inscribed with: Part I "Technical Quotation without Price" and Part II "Commercial Quotation with Price".

- 2.3 The quotation must remain valid for, at least 120 days from the date of opening of Commercial Tenders.
- 2.4 The quotation should hold good for any reduced or enhanced quantities without notice.
- 2.5 In the event of non-acceptance of offer, intimation may be given to the Tenderers on their request.
- 2.6 Conditional offers or alternative offers are likely to be ignored.
- 2.7 Quotations should be based on FOB. The consignment will be shipped through Pakistan National Shipping Corporation (PNSC). In case there is no PNSC service in the country of shipping, please quote on C & F basis. The freight should be indicated separately. Insurance premium should not be included in the quoted price. However, where insurance is considered necessary, advice to that effect should be given in the quotation.
- 2.8 Submission of the offer through an agent in Pakistan should be avoided. In case it is considered inevitable, the agent's quotation must invariably be accompanied by the original proforma invoice from the principals/manufacturers. **However, contract will be placed on principals/manufacturers.**
- 2.9 Country of origin and port of shipment to be stated
- 2.10 The offer of the principal must clearly indicate whether the rate quoted is inclusive of agent's commission, and if inclusive rate of commission included be specified.
- 2.11 Suppliers will render necessary information regarding hazardous effects on environment, of the materials/products supplied by them, in their quotations and shipping/despatch documents
- 2.12 If the requisite information is not furnished on the T.E form or offer received is not in conformity with the requirement of the T.E each offer shall be ignored.
- 2.13 The supplier will furnish a declaration regarding fees, commission and brokerage/environmental effect etc payable by the firm alongwith shipping documents.

### 3. INSPECTION

- 3.1 Supplies shall be subject to the inspection and acceptance by the competent inspection authority nominated by the Purchaser, who will arrange it at his own cost. Inspection facilities such as tools, test equipment, instruments etc will, however, be provided by the Suppliers in accordance with the relevant specifications.
- 3.2 Where considered necessary by the Purchaser, stores may be obtained on Warranty/Guarantee, subject to inspection on receipt. Rejected stores will be removed and replaced with the acceptable stores by the Supplier at his own expense, within a specified time.

**3.3 TENDER SAMPLE**

Where required offer must accompany tender sample strictly according to the description and specification given in Tender Enquiry. Offer not accompanied by tender sample will NOT be entertained excepting the established and reputable firms who have either previously satisfactorily supplied the same or similar stores or have submitted an acceptable sample thereof against previous T.E.

**4. ACCEPTANCE OF OFFERS**

- 4.1 POF may reject all bids or proposals at any time prior to the acceptance of a bid or proposals, but is not required to justify grounds for its rejection.  
POF Shall incur no liability towards suppliers or contractors who have submitted bids or proposals.

**5. BID Security**

- 5.1 A copy of Bid Security should accompany the tender in shape of deposit at call receipt/Pay Order/Banker Cheque from scheduled bank drawn in favour of: **MD MG FACTORY**
- 5.2 Bid security instrument in original must be provided on the day/date of tender opening in the Bid Center as under:
- a. Registered/indexed firms including foreign firms - 2% of quoted value subject to the maximum ceiling of Rs. 0.5 Mn.
  - b. Registered/un indexed firms including foreign firms - 3% of quoted value subject to the maximum ceiling of Rs. 0.75 Mn.
  - c. Unregistered Firms including foreign firms - 5% of quoted value subject to the maximum ceiling of Rs. 1.00 Mn.
  - d. Govt organization/production units/state owned enterprises/welfare projects of Svcs HQ - Rs 0.50 M. can be waived off on request by DG(C)
  - e. Bid money will be returned to unsuccessful (less first three lowest quotee firms) bidders on opening of commercial offers.
  - f. Bid money will be returned to successful bidders on submission of performance bond/unconditional B.G.
  - g. Quotation accompanied with less bid money will be accepted on provisional basis for 10 x days after opening of bids. However the firms are bound to provide/furnish the balance bid money within 10 x days after opening of bid otherwise such quotations will be ignored or rejected.
  - h. Offers received without Bid Security will not be entertained.
  - i. Bid money will be forfeited in case the quotation is withdrawn before the expiry of its validity date.

**6. PERFORMANCE BOND**

- (a) The successful bidder will provide Performance Bond at the rate of 10% of F.O.B value of the contract in favour of Controller Military Accounts (CMA) POF Wah Cantt. The Performance Bond will be furnished in the form of Deposit At Call Receipt (CDR) from

any scheduled bank in Pakistan or an unconditional bank guarantee on prescribed proforma covered by any scheduled bank in Pakistan. The performance Bond shall be furnished within 45 days from the date of opening of Letter of Credit. It shall be valid for a period of 12 months after the date of expiry of letter of credit. If the Performance Bond is not furnished within the prescribed time of 45 days, the Purchaser reserves the right to:

- i. Impose penalty @ 1% per month of the value of CDR/BG.  
(Clause-42 (a i) is not applicable in case of procurement of Plant/Equipment/Machinery items).
- OR
- ii. Cancel the contract and make other arrangements for purchase of the stores at the risk and expense of the Supplier.

(b) No Performance Bond will be required if the total FOB value of the contract is less than US \$50,000 and contract is placed directly on the foreign Supplier.

7. **FAILURE TO SUPPLY THE STORES**

All deliveries must be completed by the specified date. In case of failure to deliver the stores within the scheduled time should have arisen from "Force Majeure", which the purchaser may admit as reasonable ground for further time, he will allow such additional time as he may consider to have been required by the circumstances of the case. Otherwise, he will be entitled, at his discretion, to cancel the contract; and/or claim liquidated damages upto 2% but not less than 1% of the contract price of the items and their quantities for each and every month or part of a month, beyond the specified delivery date, during which these may not be delivered, subject to a maximum of 10% of the total contract value of the particular stores which remained unsupplied either in part or in full: or, to purchase from elsewhere, the unsupplied stores at the risk and cost of the supplier.

8. **PAYMENT**

Payment will normally be made by means of irrevocable letter of credit. Unless otherwise stated 70% payment may be released on submission of despatch documents to Bank along with pre-shipment inspection acceptance certificate from the purchaser. Remaining 30% payment will be released after installation, commissioning and satisfactory completion of trial run of the machines at purchaser premises against the final acceptance test certificate issued by the Purchaser.

8.1 All Bank charges incurred in Pakistan in connection with the establishment of LC will be borne by the Purchaser whereas all Bank charges incurred in connection with drawing of payment including charges for confirmation of L.C. by the advising Bank/Foreign Bank will be borne by the Supplier.

**9. SECURITY OF INFORMATION**

The tenderer and his employees must not communicate any information relating to the sale/purchase of stores under this enquiry to any person other than the manufacturer or to any press or agent not authorised in writing by POFs to receive it. Please return the Schedule to the Tender duly signed by the specified date, along with the specifications, drawings etc., if any, enclosed herewith - even if you are unable to quote.

**WARNING** In case the firm abstain from making offers or fail to return/acknowledge the tender form by the specified date on three consecutive occasions, no further tender enquiry may be issued to them and their names would liable to be removed from the approved list.

**Note:** Offers/bids through email & fax are not acceptable. The offers/bids must be submitted with warranty/guarantee certificate on firm's original letter head pad through Mail/ Courier.

Yours Faithfully



(Syed Saqlain)

MANAGING DIRECTOR-MGFY  
for PAKISTAN ORDNANCE FACTORIES

Tele 9314101, 22125

Fax 051-9314100

Telex 5840 POFAC PK

# PAKISTAN ORDNANCE FACTORIES

POF 1262

SCHEDULE TO TENDER NO. 0005/FP/54/CAPITAL PUR-MGFy DATED 27-Feb-25

S.No.	Description	Qty.	Specification
01.	CNC Surface Grinding Machine	01 Off	Attached as Annexure-A

(1) FOR MATERIALS

(2) For Plant & Machinery: Specification:-

(3) Special Conditions

Bid shall be opened as per PPRA Rule 36 d i.e two stage two envelope bidding procedure.

First stage:

In which the bid shall comprise of two separate envelopes marked " Financial Proposal & Thechnical Proposal to avoid confusion".at first stage only the envelope marked thechnical proposal shall be opened. The envelope marked as Financial Proposal shall be retained in the custody of the procuring agency without being opened.The technical proposal shall be discussed with the bidders with reference to the procuring agency's technical requirement.Those bidders willing to meet the requirement of the procuring agency shall be allowed to revise their technical proposals following these dicussions;

Bidders not willing to conform their technical proposal to the revised requirements of the procuring agency shall be allowed to withdraw their respective bids without forfeiture of their security;

Second stage:

After agreement between the procuring agency and the bidders on the technical requirements, bidders who are willing to conform to the revised technical specifications and whose bids have not already been rejected shall submit a revised technical proposal and supplementary financial proposal, according to the technical requirement. The revised technical proposal alongwith the financial proposal and supplementary financial proposal shall be opened at a date,time an venue announced in advance by the procuring agency : provided that in setting the date for the submission of the revised technical proposal and a supplementary price proposal a procuring agency shall allow sufficient time to the bidders to incoprate the agreed upon changes in the technical proposal and to prepare the required supplementary financial proposal.The procuring agency shall evaluate the whole proposal in accordance with the evaluation criteria and the bid found to be the lowest evaluated bid shall be accepted.

ALL CHINESE AND HONG KONG BASED FIRMS MUST QOUTE IN CURRENCY CHINESE YUAN (CNY)

IN CASE OF FIRST TIME BUSINESS OF FOREIGN FIRM WITH POF:

FIRM WILL PROVIDE CREDENTIAL CERTIFICATE + EXPORT LICENSE.

**PAKISTAN ORDNANCE FACTORIES**SCHEDULE TO TENDER NO. 0005/FP/54/Capital-MGFy DATED 27-Feb-25

2. Local firms can also participate on FOR basis and in case of local firm:
- (a) FIRM WILL PROVIDE TENDER FEE + BID MONEY.
  - (b) GST MUST BE SHOWN SEPARATELY.

**(4) Undertaking**

Should our offer be accepted, we hereby undertake to supply the stores/render the services contracted on the basis of Conditions of Contract embodied in Form POF 1282, and to deposit the performance bond within the prescribed time, failing which it will constitute a breach of contract, and POF will have the right to purchase the stores/services elsewhere at our risk and cost.

Place  
DateSignature of the Tenderer  
Name  
Postion  
Address  
Income Tax G.I.R. No

## Technical Specifications of CNC Surface Grinding Machine

a. Nomenclature of Machine:

CNC Surface Grinding Machine with Horizontal Spindle & Rectangular Bed

b. Quantity:

Total Machines required: Qty 01 off

c. Technical Specifications of Machine:

S#	Feature	Unit	Parameters
1.	Dimension of working portion of machine (X x Y x Z)	mm	300x1000x400
2.	Table surface (X x Y)	mm	300x1000
3.	Max. height of components	mm	250
4.	Table traverse longitudinal (Hydraulic):		
	• Maximum	mm	1110
	• Minimum	mm	200
5.	No. of T. Slot on table (min.)	Nos.	03
6.	Table Speed (stepless)	m/min	3 ~ 27
7.	Distance from Spindle axis to table:		
	• Maximum	mm	575
	• Minimum	mm	135
8.	Spindle speed	rpm	1440
9.	Grinding Wheel (Aluminum Oxide) Size	mm	350x127x40
10.	<b>Slide traverse:</b>		
	• Cross (hydraulic / manual)	mm	350
	• Vertical (manual)	mm	400
11.	<b>Feed:</b>		
	i. Vertical		
	• Hand wheel micrometer die graduated to	mm	0.005
	ii. Cross (Hydraulic)		
	• Hydraulic continuous (stepless)	m/min	0.5~4.5
• Hydraulic intermittent per stroke of table (stepless)	mm	3~30	
I.	<b>Accuracy:</b>		
	Max. Finish of components required	μm	0.8
		▽	▽▽▽7
	Min Programmable increment on X-axis	mm	0.001
Min Programmable increment on Z-axis	mm	0.001	

d. CNC Control:



Fanuc / Schneider / Siemens / Mitsubishi / GSK or equivalent (Latest version).

e. **Essential Characteristics of Machine:**

- i. Automatic lubrication system.
- ii. High pressure coolant supply.
- iii. Pneumatic unit for compressed air.
- iv. Neat oils (Straight Oils).
- v. Reinforce Concrete Bed.
- vi. Dust collectors/ dust extractors and oil filtration system.
- vii. Refrigerant based Cooling system for hydraulic units, spindle, pumps, control cabinets and electric cabinets.
- viii. Built-in voltage stabilization.

f. **Software:**

- i. Integrated Diagnostic & Alarm System.
- ii. Remote Diagnostic system for trouble shooting.
- iii. Automatic Initialization Procedure.
- iv. Software Backup & reloading/ uploading via USB & ethernet.
- v. Automatic Calibration.
- vi. Free of Cost software upgrade & downloadable via internet.
- vii. Software operate able on MS Windows operating system.
- viii. Software should be compatible with latest & upcoming versions of windows and connectivity with laptop via Ethernet and USB.

g. **Accessories:**

Accessories must be inclusive but no limited to:

- a. Electromagnetic chuck with accessories.
- b. Grinding wheel dresser and wheel puller.
- c. Wheel balancing stand with arbor & leveling screws.
- d. Magnet separator.
- e. Universal vices.
- f. Working area light.
- g. Air gun flushing function for cleaning/machine.
- h. Full enclosure guard.
- i. 01x laptop with preloaded licensed machine software and all type of backups.
- j. Standard Tool kits for maintenance.

h. **Applicable Standards:**

i.	ISO 230-1-2012	Geometric accuracy of machine
ii.	ISO 230-2-2012/2014	Determination of accuracy and
iii.	VDI-DGQ 3441	repeatability of position

iv.	ISO 230-5:2000	Noise emission
v.	ISO 841:2001 (E)	Dealing with coordinates X,Y,Z
vi.	ISO 16090-1: 2017	Safety requirements and protective measure

i. **Tooling:**

Machine should be fully tooled up, including the grinding wheels as per size mentioned above in c(9). Machine should have jigs & fixtures for production of 05x components for two years (4000 working hrs) production.

- i. **Production Rate:** 05x components for two years (4000 working hrs) production (list of components & their output is mentioned in **Annex "C"**).
- ii. Detail item wise list is to be provided alongwith unit rates in commercial offer.
- iii. Supplier will provide the life cycle graph of tooling.
- iv. Supplier will provide 02 x sets of Jigs & fixtures.

j. **Spares:**

- i. Electrical, Mechanical and Electronic spare parts for two years after warranty Guarantee period essentially required for maintenance and operation are to be supplied.
- i. Detail item wise list is to be provided alongwith unit price in commercial offer.
- ii. Backup support for provisioning of spares for 15 x years is to be ensured.

k. **Documentation:**

04x sets of following documents in English are required.

- i. 04 x sets of operating manuals in English.
- ii. 04 x sets of maintenance & service manuals in English.
- iii. Hydraulic lubrication and coolant circuit diagram with description.
- iv. Details of electrical sequence control circuit diagrams of machines
- v. Technical details of motors and their controls.
- vi. Machine layout diagram will be provided by the firm well before shipment of machine.
- vii. Brochures of the offered model.

l. **Site Condition & Available Services:**

- i. The available electric system on site for functioning of the machine is:
  - a. 400  $\pm$  5% VAC, 50Hz, 3 Phase, 4-Wire System
  - b. 230  $\pm$  5% VAC, 50Hz, 1 Phase, 2-Wire System
- ii. The available compressed air supply on site for functioning of the machine is 5  $\pm$  1 Bar.
- iii. The available process water at 40 PSI and at 20°  $\pm$  5°C.
- iv. The available climatic conditions for functioning of the machine are:
  - a. Temperature:
    - Winter = 0° to 20°C

- Summer = 30° to 50°C
- b. Relative Humidity = 25 to 90%
- c. Earthquake Value = 8.0 on Richter Scale

m. **Safety:**

Safety devices in accordance to international standards must include the followings:

- i. Over Current / Voltage Tripping System
- ii. Safety guards for rotary parts must be provided
- iii. Mechanical overload protection
- iv. Electronic overload protection
- v. The electric equipment should be earthed
- vi. Equipment should have line protection circuit breakers with electronic overload relays alongwith electro-magnetic contractors, as required. It should be followed by cut-out and safety fuses, if necessary.
- vii. All motors should be equipped with all standard safety protections and fulfill IP-52 or above ratings.

n. **Operation Cycle Time:**

- i. Machine cycle time for each component with required output in single shift has been attached as **Annex "C"**.
- ii. Overall Equipment Efficiency (OEE) not less than 85%.

o. **Training:**

- i. The supplier will provide training to POF personnel at no additional cost to the extent of 04 men for 15x working days in the field of machine setting, operating of machine, inspection, mechanical, electrical & electronics maintenance, instruments and software related to machine at supplier's or its sub contractor's premises.
- ii. Training will be imparted to the officials in parallel to the PSI of the machine.
- iii. Training expenses of POFs personnel at Supplier's premises including boarding, lodging, return Air Tickets & Daily allowance etc. will be borne by the purchaser.

p. **Pre-Shipment Inspection:**

- i. Supply of machines shall be subject to Pre-Shipment Inspection (PSI) and acceptance by the designated 02x officers for 07x working days in parallel to Training team.
- ii. The supplier shall provide assembly protocol during PSI including assembly of Control panel, Pneumatic system, Hydraulic system and electrical components.
- iii. The machine& equipment will be dispatched only after the receipt of pre-delivery trials acceptance certificate from purchaser, certifying that the machines & equipment have qualified the function / quality test and components produced have been passed in gauges requirements.
- iv. During PSI 10x components of each items will be machined. There should be No stoppage of machine, and machined component should conform in relevant gauges.
- v. Tooling & lubricants used during PSI will be provided by Supplier.

- vi. Rejected machine/equipment will be removed and replaced with the acceptable one by the Supplier at his own expense, within a specified time. The supplier will render warranty / guarantee certificate as per **Annex "E"**.
- vii. Specific materials will be used for production of components during PSI.
- viii. Expenses of POFs personnel at Supplier's premises including boarding, lodging, return Air Tickets & Daily allowance etc. will be borne by the purchaser.

q. **Installation & Commissioning:**

- i. The machine shall be commissioned and trial production of the machine shall be carried out by supplier's engineers. However, Purchaser shall provide required number of operators and technicians for the commissioning and trial production of the machine.
- ii. The supplier is to indicate the total man-weeks of his engineers / technicians required for installation, commissioning and trial production of the machine. Terms and conditions are to be stated clearly. All expenses, including boarding & lodging, air travel and daily allowances of the engineers / technicians are to be borne by the supplier. Local transportation shall be arranged by the Purchaser.
- iii. The supplier is to indicate the time schedule for the completion of whole project.
- iv. Machine layout diagram will be provided by the firm well before shipment of machine.
- v. The oil and process lubricants required 1<sup>st</sup> time to run the machines for one year shall be supplied by the supplier.

r. **Final Acceptance Test (FAT):**

- i. Final acceptance test will be performed at purchaser premises. This test will be carried out with the technical assistance of the supplier and will comprise successful production of acceptable quality of components as per Specified drawing, visual inspection and specified gauges.
- ii. **Machine Capacity Run:** Machine will be given capacity run for 14x working days in customer premises. Output of machine in terms of production capacity & quality will be checked on 05x components as mentioned in **Annex "C"**. The components produced from the input material must qualify all the specified gauges as per drawing requirements.
- iii. The supplier experts will stay, at supplier cost till the production has been achieved provided such delays are attributable to supplier. Supplier experts should stay for 01 week after successful trial run to look after / handle the machine problems at supplier's expense.
- iv. The Tooling, Spares and Process lubricants consumed during trial production run will be in addition to the original contracted/ supplied quantities by the supplier.
- v. In case, the machine could not be commissioned by the OEM, the same will be commissioned by utilizing locally available expertise at the risk and cost of the OEM.

s. **Payment Terms & Conditions:**

Payment terms & conditions are negotiable. Payment will be released through LC against shipping documents including acceptance certificate by PSI team, 10% performance bond at FOB value of contract and warranty/ guarantee certificate valid for 12x months after successful Final Acceptance Test (FAT) of the machine. The general conditions of performance bond and

payment are as under: However, firm has to provide following documents for release of payment as per accepted POF 1262

a. **Performance Bond:**

The successful bidder will provide Performance Bond at the rate of 10% of F.O.B. value of the contract in favour of CMA (Store) POF Wah Cantt. The Performance Bond will be furnished in the form of Deposit at Call Receipt from any scheduled bank in Pakistan or an unconditional bank guarantee on prescribed proforma covered by any scheduled bank in Pakistan. The Performance Bond shall be furnished within 45 days from the date of opening of letter of Credit. It shall be valid for the period of 12 months after the issuance of FAT certificate.

If the Performance Bond is not furnished within the prescribed time, the Purchaser reserves the right to cancel the contract and has the right to take risk purchase action.

b. **Payment:**

Payment will normally be made by means of irrevocable letter of credit. Unless otherwise stated 70% payment may be released on submission of despatch documents to Bank along with pre-shipment inspection acceptance certificate from the purchaser. Remaining 30% payment will be released after installation, commissioning and satisfactory completion of trial run of the machines at purchaser premises against the final acceptance test certificate issued by the Purchaser.

All Bank charges incurred in Pakistan in connection with the establishment of LC will be borne by the Purchaser whereas all Bank charges incurred in connection with drawing of payment including charges for confirmation of L.C. by the advising Bank/Foreign Bank will be borne by the Supplier.

t. **Delivery Schedule:**

- i. Delivery of machine will be made within 06x months after establishment of LC.
- ii. Delivery of machine will be made on C&F basis.
- iii. The firm to ensure export permit of the machine to POF.
- iv. LD Charges, if imposed, will be recovered up to the rate of 2% but not less than 1% of the value of un-supplied quantity of the item (s) per month or part of a month (max 10% of contract value).

u. **Country of Origin:**

- i. Europe, UK, USA, Japan, Turkiye and South Korea or any other country having license from OEM of these origins for machine manufacturing.

v. **Colour:**

- i. Preferably RAL-6011 (Reseda green)

All over  $\nabla \nabla 4$

Before Surface Grinding

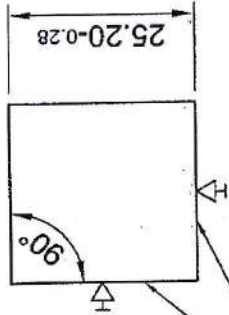
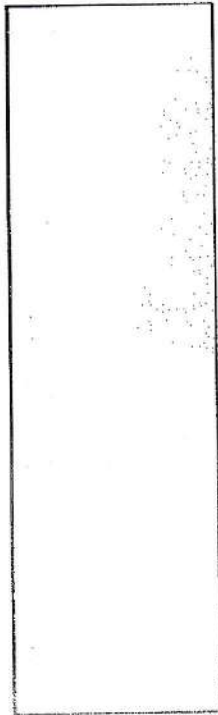

Machined surface

All over  $\nabla \nabla 6$

After Surface Grinding

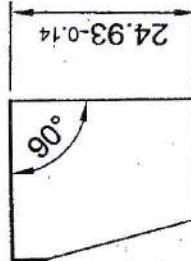
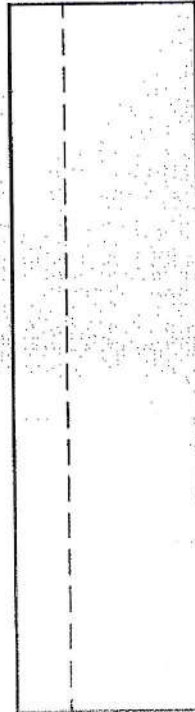

SEAR  
(Operation No. 1)

All over  $\nabla\nabla\nabla 6$

Before Surface Grinding

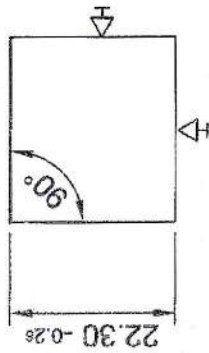
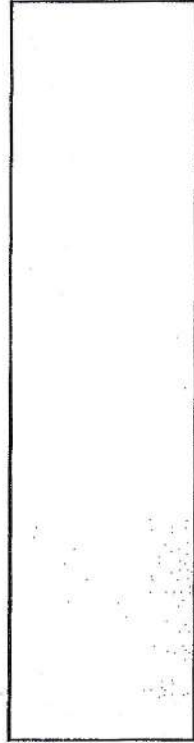

All over  $\nabla\nabla\nabla 7$

After Surface Grinding

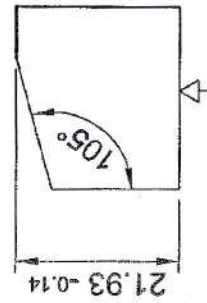
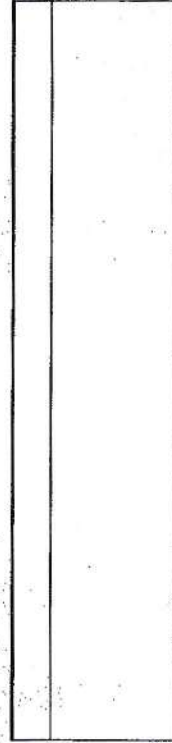

SEAR  
(Operation No. 2)

All over  $\nabla \nabla \nabla$  5

Before Surface Grinding

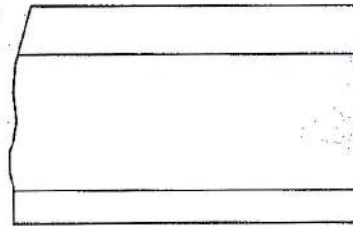
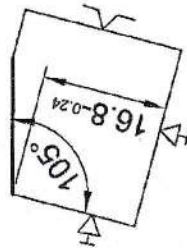
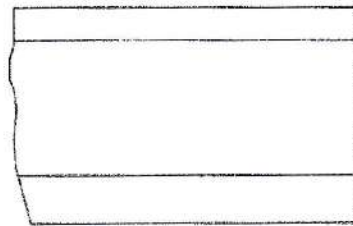
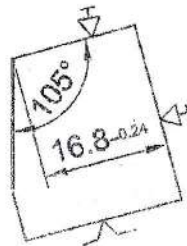

All over  $\nabla \nabla \nabla$  7

After Surface Grinding

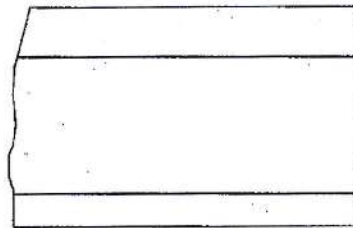
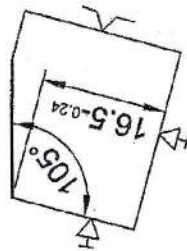
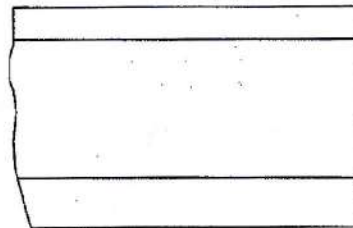
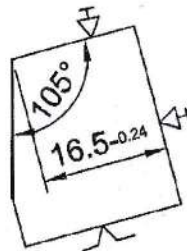

SEAR  
(Operation No. 3)



All over  $\nabla \nabla 4$

Before Surface Grinding

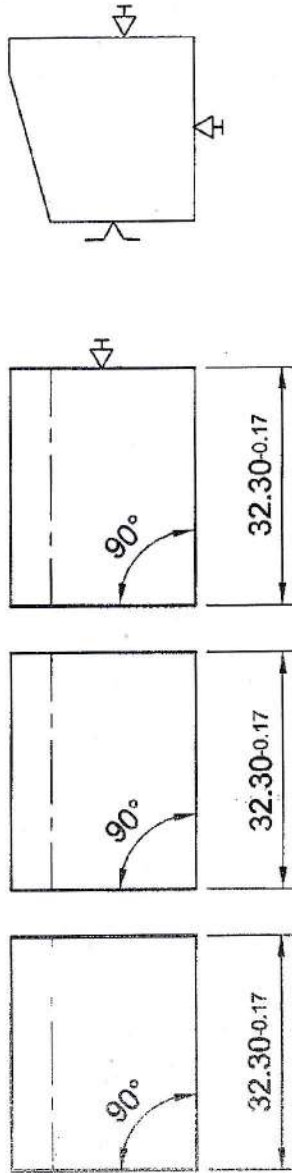

All over  $\nabla \nabla 6$

After Surface Grinding

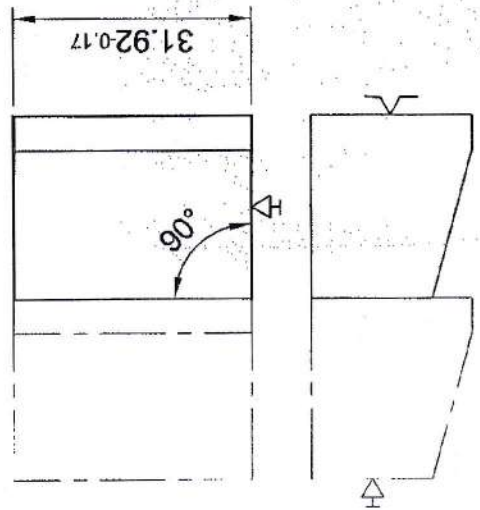

SEAR  
(Operation No. 4)

Before Surface Grinding

All over  $\nabla\nabla 4$

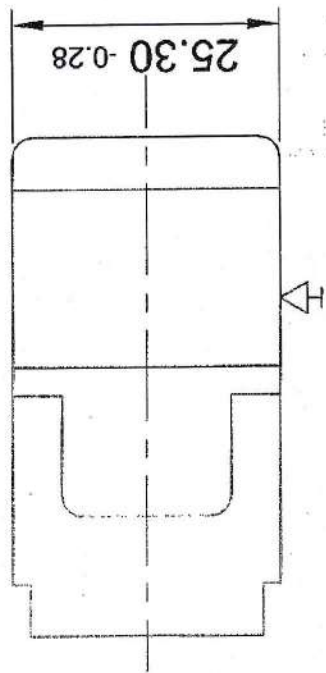

After Surface Grinding

All over  $\nabla\nabla 4$

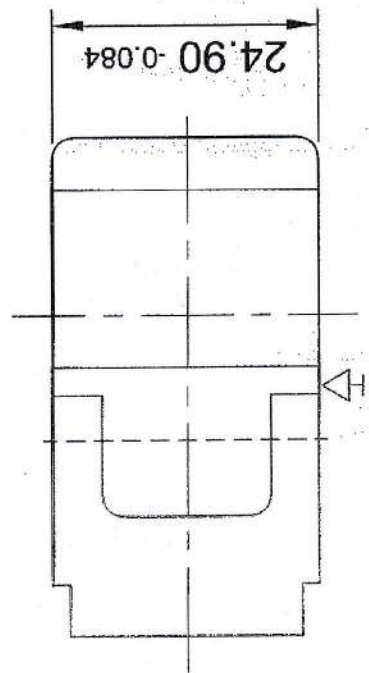

Front Sight Guard  
(Operation No.1)

Before Surface Grinding

All over  $\nabla 3$

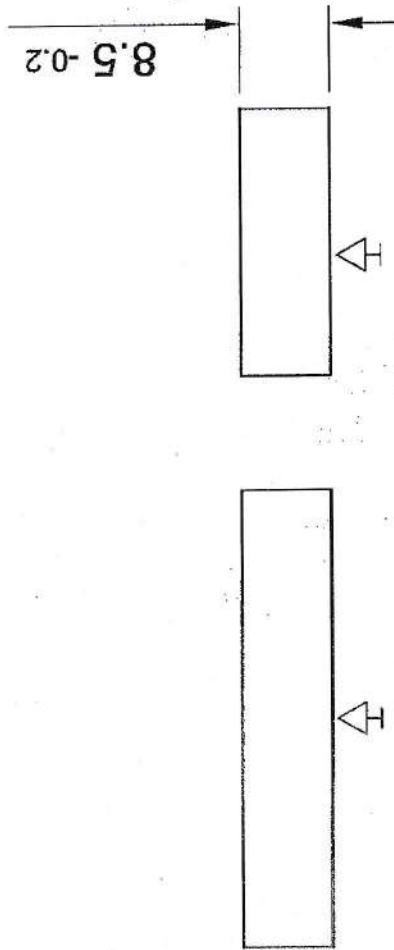

After Surface Grinding

All over  $\nabla 4$

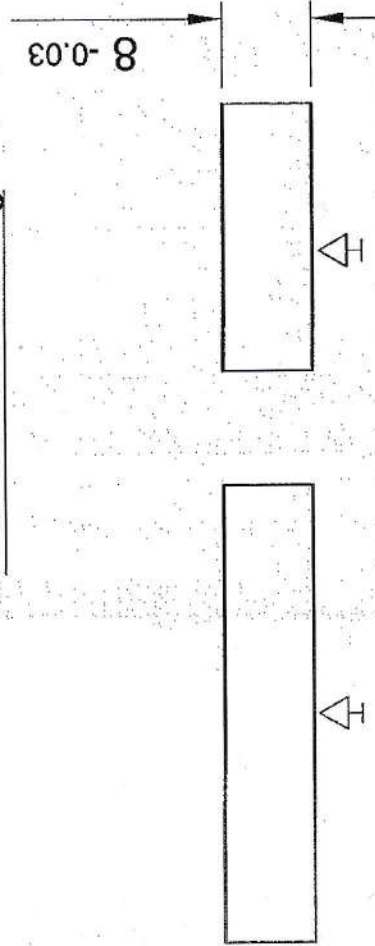

Rear Sight Slide  
(Operation No.1)

All over  $\sqrt{\sqrt{.5}}$

Before Surface Grinding

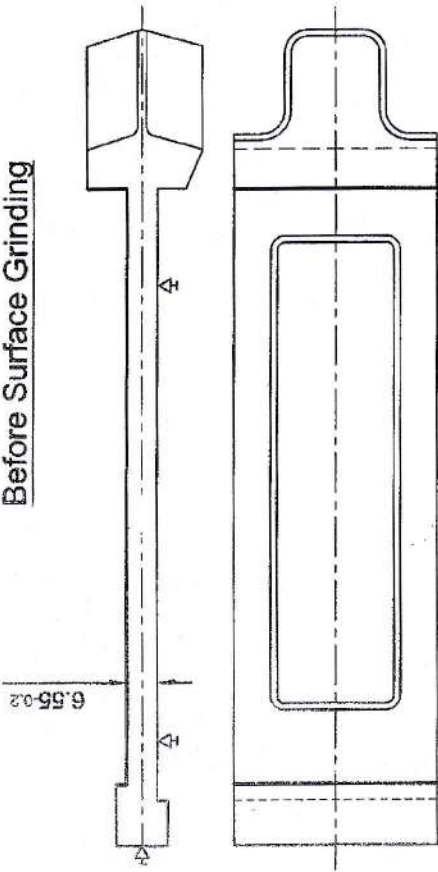

All over  $\sqrt{\sqrt{.4}}$

After Surface Grinding

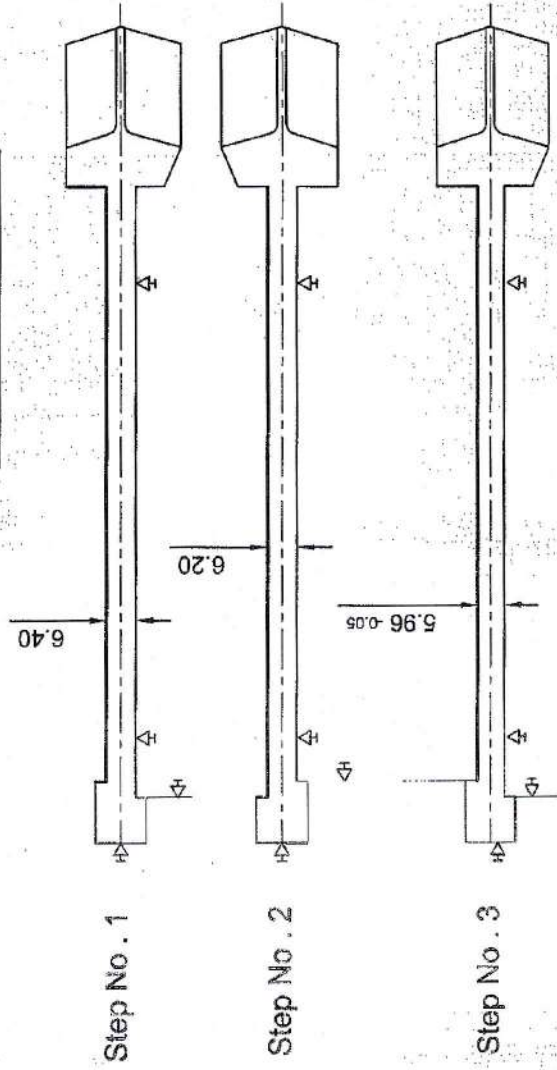

Rear Sight Leaf  
(Operation No. 1)

Before Surface Grinding

All over  $\nabla\nabla 6$

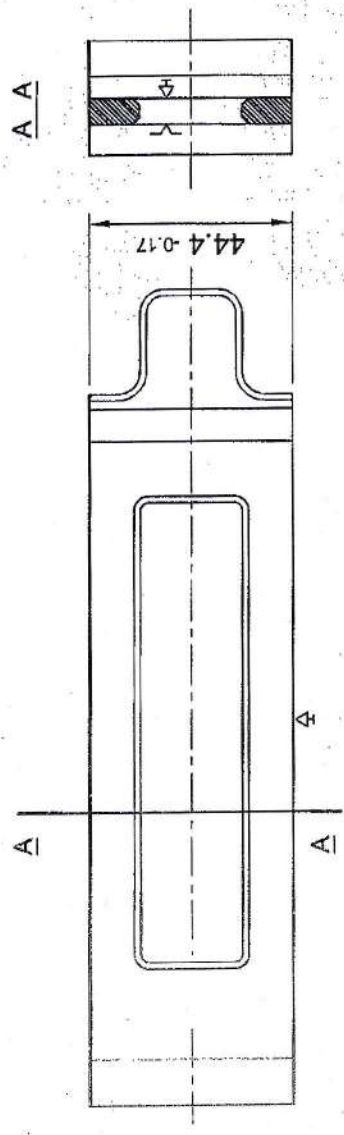

After Surface Grinding

All over  $\nabla\nabla 6$

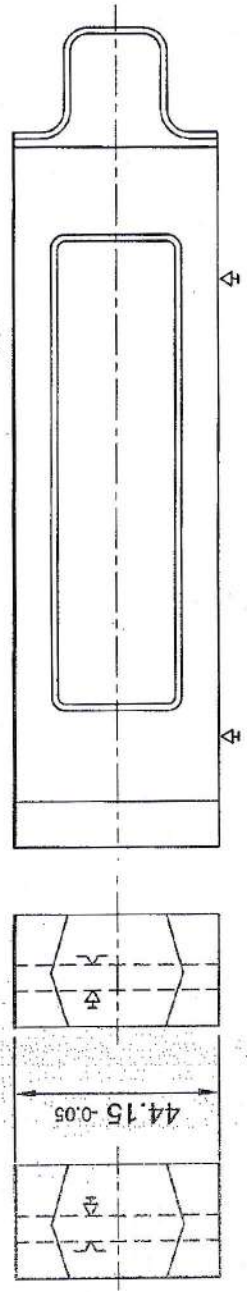

Rear Sight Leaf  
(Operation No.2)

Before Surface Grinding

All over  $\nabla\nabla 6$

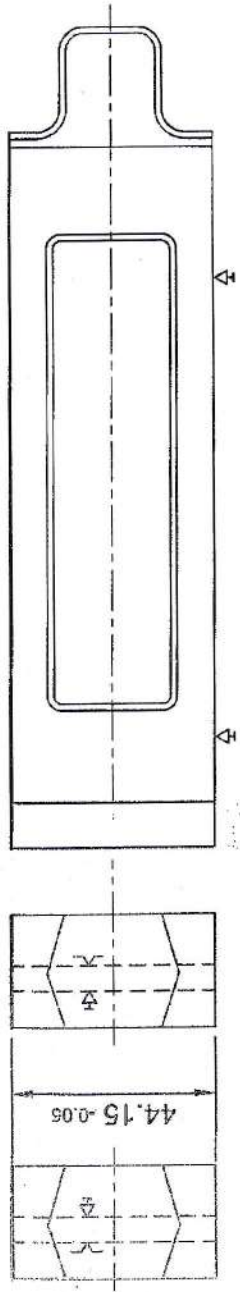

After Surface Grinding

All over  $\nabla\nabla 6$

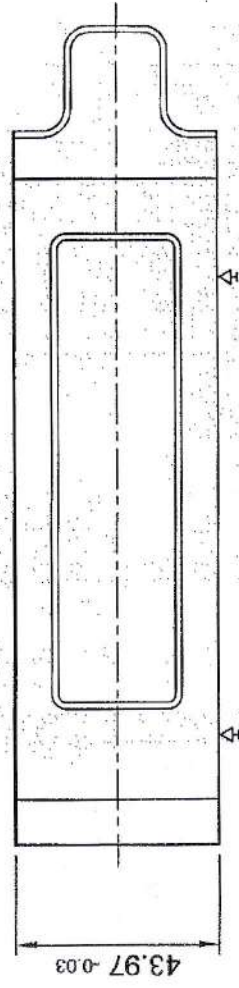

Rear Sight Leaf  
(Operation No.3)

All over  $\sqrt{\sqrt{5}}$

Before Surface Grinding

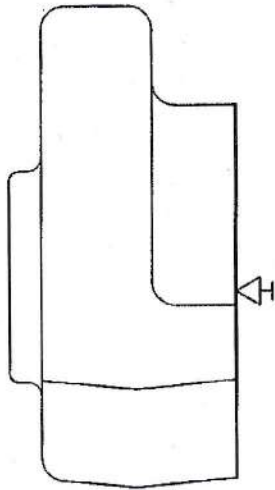
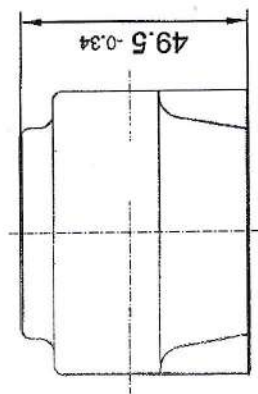

All over  $\sqrt{\sqrt{5}}$

After Surface Grinding

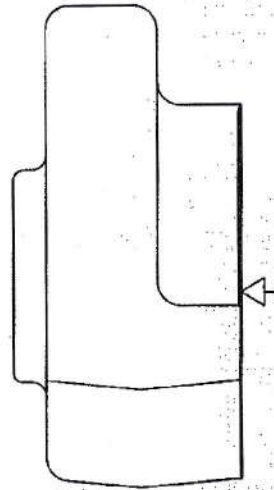
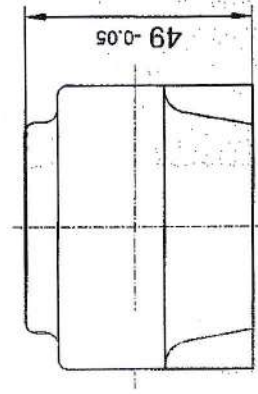

BACK PLATE BODY  
(Operation No.1)

All over  $\sqrt{\sqrt{5}}$

Before Surface Grinding

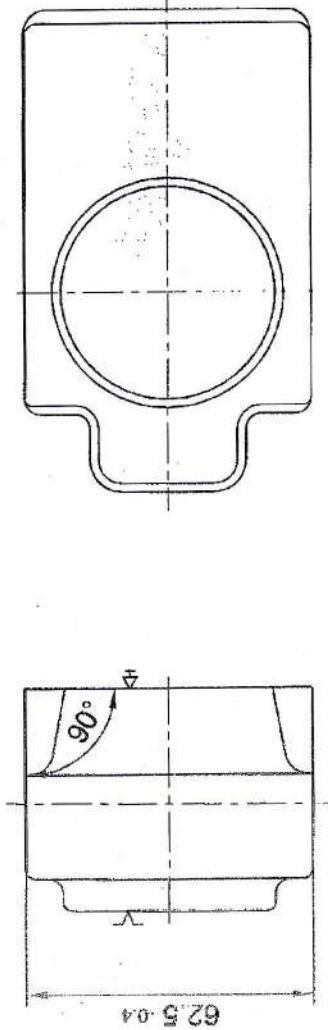

All over  $\sqrt{\sqrt{6}}$

After Surface Grinding

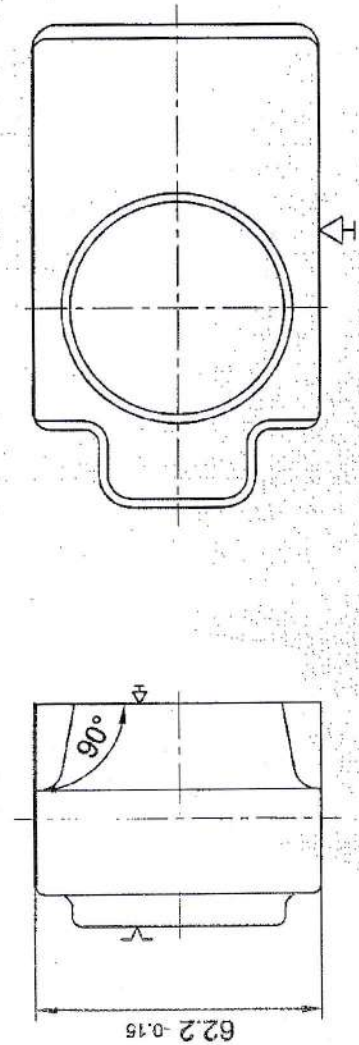

BACK PLATE BODY  
(Operation No.2)



Before Surface Grinding

All over  $\nabla\nabla 6$

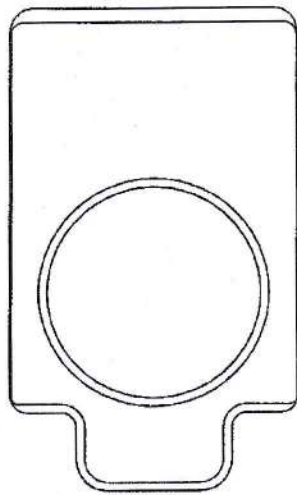
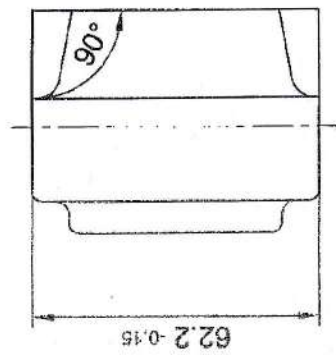

After Surface Grinding

All over  $\nabla\nabla 6$

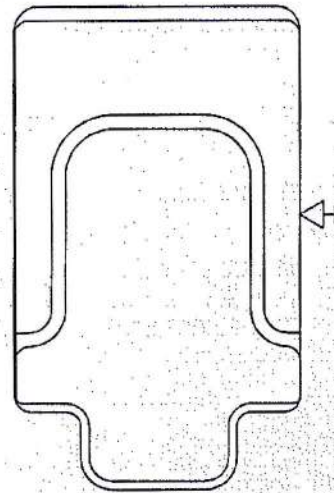
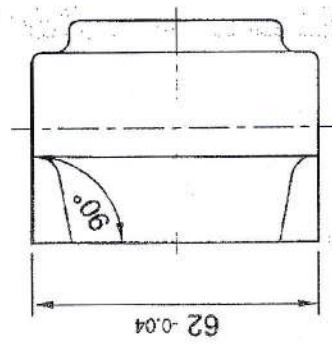

BACK PLATE BODY  
(Operation No.3)

**OUTPUT OF CNC SURFACE GRINDING MACHINE**

Sr. #	Component Name & Drg. No.	No. of Operations	Output Req'd. per Annum in Single Shift (08 hrs.)	Size before Grinding	Size after Grinding	No. of Gauges	Remarks
1.	Sear	04	500 components on each operation	Op. 1: 25.20 <sup>-0.28</sup> Op. 2: 22.30 <sup>-0.28</sup> Op. 3: 16.80 <sup>-0.24</sup> Op. 4: 32.30 <sup>-0.17</sup>	Op. 1: 24.93 <sup>-0.14</sup> Op. 2: 21.93 <sup>-0.14</sup> Op. 3: 16.50 <sup>-0.24</sup> Op. 4: 31.92 <sup>-0.17</sup>	04	
2.	Front Sight Guard	01	1000 components on each operation	25.30 <sup>-0.28</sup>	24.90 <sup>-0.084</sup>	01	
3.	Rear Sight Slide	01	500 components on each operation	8.50 <sup>-0.2</sup>	8.00 <sup>-0.03</sup>	01	
4.	Back Plate Body	03	500 components on each operation	Op. 1: 49.5 <sup>-0.34</sup> Op. 2: 62.50 <sup>-0.4</sup> Op. 3: 62.2 <sup>-0.15</sup>	Op. 1: 49 <sup>-0.05</sup> Op. 2: 62.2 <sup>-0.15</sup> Op. 3: 62 <sup>-0.04</sup>	04	
5.	Rear Sight Leaf	03	1000 components on each operation	Op. 1: 6.55 <sup>-0.2</sup> Op. 2: 44.4 <sup>-0.17</sup> Op. 3: 44.15 <sup>-0.05</sup>	Op. 1: 5.96 <sup>-0.05</sup> Op. 2: 44.15 <sup>-0.05</sup> Op. 3: 43.97 <sup>-0.03</sup>	03	

**LIST OF SPARES**

- a. 01 x No. of each type of pump used in hydraulic lubrication circuit.
- b. 05 x No. of each type of filter element used in hydraulic and lubrication circuit.
- c. 02 x No. of each type direction control, pressure relief, pressure reducing and non-return valves used in hydraulic and lubrication circuit.
- d. Complete 02 x set of sealing used in machine.
- e. Complete 02 x set of hose pipes used in machine.
- f. Complete 02 x set of compressor / tension springs used in machines
- g. 05 x set of fuzes (if less than 2Amp) should be given.

**WARRANTY /GUARANTEE CERTIFICATE**

Firm's Name: M/s \_\_\_\_\_

Contract No. \_\_\_\_\_, Date: \_\_\_\_\_

The Seller guarantees the high quality of delivered goods and their full conformity to the contract conditions. The delivered goods should be in accordance with the technical conditions of the company-producer and should be confirmed by the quality certificate of the company-producer.

Quality and quantity acceptance should be affected on the territory of the Buyer. The guarantee period is 12 months since date of start-up, but not more than 18 months from date of shipment.

Excluded from our warranty are parts subjects to normal wear and tear, damages due to incorrect storage and starting up, poor maintenance and damages due to corrosion of cavitations.

The liability of the SELLER is limited to replace damages concurred on the delivered GOODS itself (direct damages). All subsequent damages (indirect damages), including loss of production and loss of profit are excluded from SELLER's liability.

For personal injuries, which are covered by SELLER's product liability is not applicable.

The Buyer has the right to raise a claim to the Consignor:

- i. in relation to the quality: in case of non conformity to quality requirement during guarantee period;
- ii. in relation to the quantity: in case of lack of places or non-conformity to the Specification not later that 45 days from the date of receipt of goods.

The subject and the ground of the claim are to the confirmed by the report. The present report is binding for both parties and it confirms the quality and the quantity of goods received by the Buyer. The Seller must consider a claim and reply within 20 working days from the date of receipt of the claim.

Otherwise, in case of non-reply during 20 days, the claim is considered accepted. In the case delivery of non-qualitative goods, the Seller is obliged to replace them by the goods corresponding to quality requirements.

All transportation and customs charges related to the replacement and repairing of goods are borne by the Seller.

Signature \_\_\_\_\_

Name \_\_\_\_\_

Status in the Firm \_\_\_\_\_

Dated \_\_\_\_\_

**TECHNICAL COMPARISON**

(TO BE FILLED BY SUPPLIER)

**TE No. 0005/FP/54/Capital Pur-MGFy DATED 27-Feb-25**

Sr. #	TENDER SPECIFICATIONS	OFFERED SPECIFICATIONS WITH REFERENCE TO PAGE NO. OF QUOTATION

**BID QUALIFICATION & SELECTION CRITERIA**  
**TE No. 0005/FP/54/Capital Pur-MGFy DATED 27-Feb-25**

Sr #	Technical/Commercial aspects to be considered to ease out most advantageous bid	Compliance Level			Remarks
		Fully Complied	Partially Complied	Not Complied	
1*	Bid submitted in compliance with PPRA Rule 36(d)				
2*	Confirm to Tender Specification				
3*	Confirm Tender Quantity (s)				
4	Complete Technical literature/Brochure/catalogue provided in first go along with technical				
5.	Prices are valid for any reduced quantity(s) without notice				
6*	120 days bid validity from date of opening of commercial offers/bid confirmed				
7	Confirm Delivery period 06 xmonths after issuance of contract				
8	Payment terms as per tender enquiry				
9	In case of new entrant, proof of past performance/ list of identical supplies to prove capabilities in the relevant filed				
10*	Certificate regarding fulfillment of all tender requirements				
11*	T.E undertaking-Signed/Stamped				
12*	Offer/Bid (Tech+Comm) is un conditional				
13*	Complete company profile				
14	Certificate that firm is not blacklisted or under debarment by any Govt/Semi Govt Organization				
15.	Confirmation of performance Bond against LC as per T.E Clause-6				
16*	Main Features as per Annex "A" of T.E				
17*	Technical Requirements as per Annex "A" of T.E				
18*	Site & Operating Conditions as per Annex "A" of T.E				
19*	Country of Origin as per Annex "A" of T.E				
20*	Specification for Electric Supply System as per as per Annex-A				
21*	Literature Required as per Annex "A" of T.E				
22*	Spares,Tools & Partsas per Annex "A" of T.E				
23*	Terns & Conditions as per Annex "A" of T.E				
<b>Note:-</b> Clause with (*) are necessary to be complied. In case of non-compliance of the same, the bid may be disqualified					