



POF-1262
(FOREIGN SUPPLIES)

GOVERNMENT OF PAKISTAN
PAKISTAN ORDNANCE FACTORIES
TENDER ENQUIRY

To

Dear Sirs,

Reference: Tender Enquiry NO. **POF-7100-FP-Capt(2) -Pur-TAF, DATED 26.08.2024**. Offers should be sent duly sealed in an envelope. Please note the following instructions for filling the tender:-

1. **SUBMISSION OF TENDER**

- 1.1 Tenders will be opened at 1100 hours on **21.10.2024** and must reach at Bid Centre POF Wah Cantt on or before **10:30 hours** on same date. The tender received late will not be entertained. You may witness the opening of the tender if you so desire. If a representative is deputed, he should bring a letter of authority from you.
- 1.2 Only one tender should be included in one envelope. The outside of the envelope should be inscribed with:-

Tender Enquiry No: **POF-7100-FP-Capt(2) -Pur-TAF, DATED 26.08.2024**

Tender to be opened on: **21 .10.2024 on 1100 hrs**

Address as follows:-
Incharge Bid Centre
Adjacent to Rabita Hall
POF Wah Cantt

- 1.3 If envelop do not indicate reference of TEs or received late, the same will be returned un opened.

2. **GENERAL INSTRUCTIONS REGARDING PREPARATION OF QUOTATIONS**

T.E will be opened as per PPRA Rule 36(d) i.e., Two stage, two envelope method. Case would be processed as per PPRA Rules / POF Purchase Procedure and contract would be awarded to most Advantageous Bidder on the basis of **Bid Qualification Criteria (Annex-B)**.

- 2.1 **For Plant and Machinery**, you are required to quote in two parts:-

Part-I: “Technical Offer” It should exclusively give technical details and literature / brochures of the offered plant, machinery & equipment, validity date, delivery schedule and signed undertaking given on the schedule to this tender enquiry. It must not indicate price, costs etc. Country of origin should be clearly mentioned.

Part-II: “Commercial Offer” It should indicate the commercial terms e.g. price, terms of payment, mode of payment, mode of supply.

Each part should be placed in a separate sealed cover. The envelopes should be inscribed with Part-I “Technical Quotation without price” & Part-II “Commercial Quotation with price”.

- 2.2 The quotation must remain valid for, **at least 180 days** (extendable) from the date of opening of commercial offer.

Contd....P/2

- 2.3 The quotation should hold good for any reduced quantities without notice.
- 2.4 In the event of non-acceptance of offer, intimation may be given to the Tenderers on their request.
- 2.5 Conditional offers or alternative offers are likely to be ignored.
- 2.6 Quotations should be based on FOB / C&F. The freight should be indicated separately. Insurance premium should not be included in the quoted price. However, where insurance is considered necessary, advice to that effect should be given in the quotation.
- 2.7 Submission of the offer through an agent in Pakistan should be avoided. In case it is considered inevitable, the agent's quotation must invariably be accompanied by the original Proforma Invoice from the principals/ manufacturers.
- 2.8 Country of origin and port of shipment to be stated.
- 2.9 Supplier will render necessary information regarding hazardous effects on environment, of the materials/products supplied by them along with shipping/ dispatch documents.
- 2.10 The supplier will furnish a declaration regarding Fees, Commission & Brokerage etc payable by the firm along with shipping documents.
- 2.11 If the requisite information is not furnished on the TE form or offer received is not in conformity with the requirement of the TE each offer should be ignored.
- 2.12 Obtaining of Export permit is responsibility of the foreign firm / supplier.

3. Pre-shipment Inspection (PSI)

- 3.1 PSI of machine at firm's premises will be conducted by 03 x POF Engineers for 01 x week.
- 3.2 The inspection team besides others will particularly carryout trial run of machines and it will be considered satisfactory subject to production of 80 components as per **Sketch No. TA/13** with a cycle 20 min per job or mentioned in the contract.
- 3.3 PSI will include demo of all functions of machine, accuracy, test run and cutting cycle time
- 3.4 Dispatch of components, materials / gauges to carry out trial run at firm's premises will be the sole responsibility of firm through local rep / foreign contractor at their own arrangements / expenses.
- 3.5 Boarding & lodging including food expanses, return air tickets and daily allowance (DA) per person per day will be borne by POF.

4. TRAINING

- 4.1 Supplier will provide free of cost training for 02 weeks for 05 x POF engineers/Technicians on programming, operating and maintenance at manufacturer's premises on the machine.
- 4.2. During training, **200 components as per attached drawing will be manufactured on continuous run.**
- 4.3 Boarding & lodging including food expanses, return air tickets and daily allowance (DA) per person per day will be borne by POF.

5. INSTALLATION & COMMISSIONING & Final Acceptance Test

- 5.1 Installation & commissioning of machine at T.A. Factory POF Wah shall be responsibility of supplier.
- 5.2 The machine will be tried out for Capacity Run and at least 120 components as per **Sketch No. TA/13** will be produced on continuous run at purchaser premises with a cycle time of 20 min per job.
- 5.3 FAT certificate will be issued after successful demonstration of all functions of machine, test run, proving of accuracy and cycle time.
- 5.4 Boarding & lodging including food expanses and return air tickets will be borne by supplier

6. LITERATURE REQUIRED

04 x sets of following documents in **English language** are required:

- 6.1 Electric & control circuit of machine.
- 6.2 Operating Manual
- 6.3 Maintenance & Service Manual.
- 6.4 Schematic diagram of each PCB.
- 6.5 Details of Motors and their control.
- 6.6 Spec of recommended cutting oil, coolant, hydraulic oil and lubricant

7. ADDITIONAL EQUIPMENTS (Item wise prices should be quoted separately)

- 7.1 Angular top Rest Blade for through feed, - Qty 02 No.
(suitable for T.A Rod as per Sketch No. TA/13)
- 7.2 Guide plate for work rest - Qty 02 No.
- 7.3 Grinding wheel (must be manufactured in single piece) - Qty 03 No.
(Grade suitable for TA Rod as per Sketch No. TA/13)
- 7.4 Regulating / Supporting Wheel - Qty 01 No.
- 7.5 Diamond dresser for grinding wheel & supporting wheel - Qty 03 No.
- 7.6 Detailed industrial tool kit trolley (150 pieces) - Qty 02 No.

7.7 Spare Parts

- 7.7.1 Machine OEM to supply electronic, electrical and mechanical spare parts for 5000 operating hrs.
- 7.7.2 Complete list with price is required as part of quotation for machine
- 7.7.3 Spare parts finalized by the purchaser will be part of contract
- 7.7.4 Spare parts list will be negotiable during PSI, provided total amount remain within contracted value.
- 7.7.5 Note: Surety for availability of Spares for minimum 10 years is required

8 Setting of Machine

- 8.1 OEM will tool up machine for manufacture of POF desired component(s) **as per Sketch No. TA/13.**
- 8.2 Raw material in shape of rod for trial will be provided by POF however, the same will be dispatched to firm's premises through local rep / foreign contractor at their own arrangement / expense.

8.4 Cycle Time of Operation

- 8.4.1 Minimum production of 80 components as per **sketch No. TA/13** with a cycle 20 min per job or mentioned in the contract is essentially required.
- 8.4.2 OEM will work out and provide machine floor to floor cycle time study with technical offer.

9. Warranty / Guaranty.

- 9.1 The Supplier will render Warranty/Guarantee certificate in duplicate to the Purchaser as soon as machine has been dispatched/delivered.
- 9.2 This Warranty/Guarantee shall be binding on the Supplier for a period of 12 months reckoning from the date of final acceptance certificate after installation/commissioning of machine.
- 9.3. In case, after receipt at consignee's ware-house, equipment is found not conforming to relevant spec and other particulars or becomes faulty in warranty period, the Supplier shall immediately replace the same free of cost and without obligation to the Purchaser

10. ACCEPTANCE OF OFFERS

The right to accept or reject any offer in full or in part is hereby reserved. However, rejection grounds shall be intimated to the tenderer upon request.

11. PAYMENT TERMS

- 11.1 Payment will be made by means of an irrevocable Letter of credit.
- 11.2 70% payment against shipping documents & acceptance report by PSI team of consignee as well as issuance of PSI Acceptance Certificate by the purchaser /consignee.
- 11.3 30% payment after successful commissioning of machine at purchaser premises against issuance of FAT certificate by the consignee on successful trial run and acceptance of all deliverables (spares/ tooling, accessories/ lubricants, software, manuals/standards/catalogues etc.)

All Bank charges incurred in Pakistan in connection with the establishment of L.C. will be borne by the Purchaser, whereas all Bank charges incurred in connection with drawing of payment including charges for confirmation of L.C. by the advising Bank/Foreign Bank will be borne by the Supplier.

12. Tender Fee:- The tender must be accompanied by a non-refundable fee by means of a cross postal order / pay order for Rs 500/- in favor of Director Admin POFs Wah Cantt.

13. Bid Security

- 13.1 A copy of Bid Security should accompany the tender in shape of deposit at call receipt / Pay Order / Banker Cheque from scheduled bank drawn in favour of:-
GM-PP&C-POF Gdl & TAF
- 13.2 Bid security instrument in original must be provided on the day / date of tender opening in Bid Centre as under:-
- Registered / indexed firms – 2% of quoted value subject to the maximum ceiling of Rs 0.5 Mn.
 - Registered / un-indexed firms - 3% of quoted value subject to the maximum ceiling of Rs 0.75 Mn.
 - Un-Registered firms - 5% of quoted value subject to the maximum ceiling of Rs 1.00 Mn.
 - State owned organizations are not required to provide Bid Security.
 - Bid money will be returned to unsuccessful (less first three lowest quote firms) bidders on opening of commercial offer.
 - Bid money will be returned to successful bidders on submission of performance bond / unconditional B.G.
 - Offers received from local bidders without Bid Security will not be entertained.
 - Bid Money will be forfeited in case the quotation is withdrawn before the expiry of its validity date.

14. PERFORMANCE BOND

- 14.1 The successful bidder will provide Performance Bond at the rate up to 10% F.O.B value of contract in favour of the Controller Military Accounts (CMA) POF, Wah Cantt. The Performance Bond will be furnished in the form of Deposit at Call Receipt (CDR) from any scheduled bank in Pakistan or any unconditional Bank Guarantee on prescribed proforma covered by any scheduled bank in Pakistan. The Performance Bond shall be furnished within 45 days from the date of opening of Letter of Credit. It shall be valid for a period of 12 months after FAT and receipt / acceptance of all the deliverables.
- 14.2 No Performance Bond will be required if the total value of the contract is less than US\$ 50,000 and contract is placed directly on the foreign Supplier.
- 14.3 If the supplier fails to furnish the Performance Bank Guarantee within specified time, such failure will constitute a breach of contract and Purchaser shall be entitled to make other arrangements for purchase of the store at the risk and expense of the supplier.

15 FAILURE TO SUPPLY THE STORES

All deliveries must be completed by the specified date. If the failure to deliver the stores within the scheduled time should have arisen from "Force Majeure", which the Purchaser may admit as reasonable ground for further time, he will allow such additional time as he may consider to have been required by the circumstances of the case. Otherwise, he will be entitled, at his discretion, to cancel the contract; and/or, claim liquidated damages upto 2% but not less than 1% of the contact price of the items and their quantities for each and every month, beyond the specified delivery date, during which these may not be delivered, subject to a maximum of 10% of the total contract value; or, to purchase from elsewhere, the unsupplied stores at the risk and cost of the Supplier.

16. SECURITY OF INFORMATION

The tenderer and his employees must not communicate any information relating to the sale/purchase of stores under this enquiry to any person other than the manufacturer or to any press or agent not authorized in writing by POFs to receive it.

Please return the Schedule to the tender duly signed by the specified date, alongwith the specifications, drawings etc, if any, enclosed herewith even if you are unable to quote.

Warning: In case the firm abstain from making offer or fail to return / acknowledge the tender form by the specified date on three occasions no further tender enquiry be issued to them and their name would be liable to be removed from the approved list

Yours faithfully,

-Sd-
(Iftikhar Ahmad Bajwa)
G.M-PP&C POF Gdl
For Pakistan Ordnance Factories
mdgdl@pof.gov.pk

PAKISTAN ORDNANCE FACTORIES

SCHEDULE TO TENDER ENQUIRY NO. POF-7100-FP-Capt(2)-Pur-TAF, DATED 26.08.2024

(1) FOR MATERIALS

(2) **FOR PLANT & MACHINERY:**

(1)	(2)	(3)	(4)	(5)		(6)
Item no.	Description with specs. etc.	Unit	Qty	Price per Unit FOB/C&F		Delivery Date
				In Figures	In Words	
1	Center Less Grinding Machine Spec: As per attached Annex 'A'.	No	01			Within 06 x months from the date of opening of LC

Specifications: - **Annexure "A"** 04 Sheets(3) Special Conditions. - **Annexure "B"** (Bid Qualification Criteria) 01 sheet**Annexure "C"** (Sketch No. TA/13). 01 Sheet(4) **Undertaking**

Should our offer be accepted, we hereby undertake to supply the stores/render the Services contracted on the basis of Conditions of contract embodied in Form POF 1280 and to deposit the performance bond within the prescribed time, failing which it will constitute a breach of contract, and POF will have the right to purchase the stores/services elsewhere at our risk and cost.

Place

Date

Signature of the Tenderer.....

Name

Position

Address

Income Tax G.I.R. No.....

Centre less Grinding machine

1. MAIN FEATURES

1.1. Component Size	Diameter	Φ20-40 mm
	Length	300-1000 mm
1.2. Surface Finish required after grinding	1.6 – 6.3 μm (▽▽)	
1.3. Grinding Wheel Dimensions (OD x width x ID)	Φ 650 x 650 x Φ304 mm	
1.4. Grinding wheel speed	Up to 1500 R.P.M min	
1.5. Regulating/ supporting wheel dimensions (OD x width x ID)	Φ 400 x 650 x Φ203 mm	
1.6. Regulating/ supporting wheel speed	10 to 300 RPM	
1.7. Regulating wheel tilting	-4° - +6	
1.8. Regulating wheel swivel	± 5°	
1.9. Cross feed per hand wheel revolution	0.3 mm/rev	
1.10. Cross feed per single tooth turn of knob (Least count)	0.003 mm	
1.11. Motor(s) Rating	As per requirement of machine	
1.12. Machine Color	Color should be standard RAL 6011	

2. TECHNICAL REQUIREMENTS

Machine should have following attachments / requirements

- 2.1. Through Feed Work Rest with adjustable Guide Plate
- 2.2. Angular top Rest Blade for through feed, (suitable for T.A Rod as per drawing No. TA/13)
- 2.3. Hydraulic system suitable to produce necessary pressure as per requirement of job & m/c
- 2.4. Cutting Fluid tank/cooling system including pump (suitable for cooling job & all necessary parts)
- 2.5. Coolant Filtration and magnetic separator system (suitable for proper disposal of grinding waste)
- 2.6. Central lubricating system suitable for lubrication of all moveable parts of machine
- 2.7. Built in system for dressing of grinding & supporting wheel along with diamond dressers
- 2.8. Grinding & supporting wheels along with supporting Mounts, Wheels Flange & Extractors
- 2.9. Balancing stand for grinding wheel with Arbor
- 2.10. Tool kit for operator / maintenance
- 2.11. Suitable lights at all appropriate locations
- 2.12. Leveling pads and accessories for grouting
- 2.13. Built in Voltage stabilizer (input voltage 360-440 VAC)

2.14. Safeties

- a. All safeties to ensure machine, operator/setters, operations, interlocking, handling, manual programming, and setting must be incorporated in the software package.

2.15. Noise Level

- a. Noise level should be according to NEQS i.e less than 75db.

3. SITE & OPERATING CONDITIONS

- a. Air Pressure available = 06 bar
- b. Temperature variation between Winter and Summer is from 0°C to 50°C
- c. Relative humidity varies from 15%~ 90% RH

4. COUNTRY OF ORIGIN

- 4.1. Europe, UK , USA, Turkey , Japan, South Korea or any other country manufacturing under license of OEMs from these countries

5. SPECIFICATION FOR ELECTRIC SUPPLY SYSTEM

Note: International Electro Technical Commission (IEC) recommended spec will be acceptable

5.1. Power Supply

- a. 415 \pm 2.5 % VAC, 50 Hz, 3 Phase, 4-wire system
- b. 240 \pm 2.5 % VAC, 50 Hz, 1 Phase
- c. Connected Load Equal or less than 50 KVA
- d. The equipment should be Earthed
- e. The equipment should have line protection circuit breaker with thermally delayed overload release and or electro – magnetic quick – acting release, as required
- f. All motors should be appropriately protected with IP rating 54 or above
- g. Industrial electrical measuring instruments should have an accuracy of Class 1 or better

5.2. Insulation

- a. The requirement is for class F insulation

6. LITERATURE REQUIRED 04 x sets of following documents in **English language** are required:

- 6.1. Electric & control circuit of machine
- 6.2. Operating Manual
- 6.3. Maintenance & Service Manual
- 6.4. Schematic diagram of each PCB
- 6.5. Details of motors and their control
- 6.6. Spec of recommended cutting oil , coolant , hydraulic oil and lubricant

7. ADDITIONAL EQUIPMENTS (Item wise prices should be quoted)

- | | |
|---|--------|
| 7.1. Angular top Rest Blade for through feed,
(suitable fo T.A Rod as per drawing No. TA/13) | Qty 02 |
| 7.2. Guide plate for work rest | Qty 02 |
| 7.3. Grinding wheel (must be manufactured in single piece)
(Grade suitable for TA Rod as per drg. No. TA/13) | Qty 03 |
| 7.4. Regulating / Supporting Wheel | Qty 01 |
| 7.5. Diamond dresser for grinding wheel & supporting wheel | Qty 03 |
| 7.6. Detailed industrial tool kit trolley (150 pieces) | Qty 02 |

7.7. Spare Parts

- a. Machine OEM to supply electronic, electrical and mechanical spare parts for 5000 operating hrs
- b. Complete list with price is required as part of quotation for machine
- c. Spare parts finalized by the purchaser will be part of contract
- d. Spare parts will be negotiable during PSI, provided total amount remain within contracted value
- e. Note: Surety for availability of spares for minimum 10 years is required

8. TERMS & CONDITIONS

8.1. Setting of machine

- a. OEM will tool up the machine for manufacturing of POF desired component (as per drawing No. TA/13)
- b. Raw material in shape of rod for trial will be provided by POF (**Detail as per T.E. Clause 3.4**)

8.2. Cycle time of operation

- a. Minimum production of 80 components as per Sketch No. TA/13 with a cycle 20 min per job or mentioned in the contract is essentially required
- b. OEM will work out and provide machine floor to floor cycle time study with technical offer

8.3. Training

- a. Supplier will provide free of cost training for 02 weeks for 05 x POF engineers/Technicians on programming, operating and maintenance at manufacturer's premises on the machine
- b. During training , 200 components as per attached drawing will be mfctrd on continuous run
- c. Boarding & lodging including food expanses, return air tickets and daily allowance (DA) per person per day will be borne by POF

8.4. Pre Shipment Inspection (Detail as per T.E. Clause 3)

- a. PSI of machine at firm's premises will be conducted by 03 x POF Engineers for 01 x week
- b. The inspection team besides others will particularly carryout trail run of machines and it will be considered satisfactory subject to production of 80 components as per Sketch No. TA/13 with a cycle 20 min per job or mentioned in the contract
- c. PSI will include demo of all functions of machine , accuracy , test run and cutting cycle time
- d. Dispatch of components , materials/gauges to carry out trial run at firm's premises will be the sole responsibility of firm through local rep
- e. Boarding & lodging including food expanses, return air tickets and daily allowance (DA) per person per day will be borne by POF

8.5. Installation/Commissioning & FAT

- a. Installation & commissioning of machine at POF Gadwal shall be responsibility of supplier
- b. The machine will be tried out for Capacity Run and at least 120 components as per Sketch No. TA/13 will be produced on continuous run at purchaser premises with a cycle time of 20 min per job
- c. FAT certificate will be issued after successful demonstration of all functions of machine, test run, proving of accuracy and cycle time
- d. Boarding & lodging including food expanses and return air tickets will be borne by supplier

8.6 Warranty/Guarantee

- a. The Supplier will render Warranty/Guarantee certificate in duplicate to the Purchaser as soon as machine has been dispatched/delivered
- b. This Warranty/Guarantee shall be binding on the Supplier for a period of 12 months reckoning from the date of final acceptance certificate after installation/commissioning of machine
- c. In case , after receipt at consignee's ware-house, equipment is found not conforming to relevant spec and other particulars or becomes faulty in warranty period, the Supplier shall immediately replace the same free of cost and without obligation to the Purchaser

8.7 Performance Bond (Detail as per T.E. Clause 14)

- a. Successful bidders shall provide Performance Bank Guarantee of 10% of FOB value of contract
- b. It shall be valid for 12 months after date of satisfactory installation/commissioning and issuance of final acceptance test certificate (FAT) of the machine

8.8 Payment Terms (Detail as per T.E. Clause 11)

- a. Payment will be made by means of an irrevocable Letter of credit
 - b. 70% payment against shipping documents & acceptance report by PSI team of consignee as well as issuance of PSI Acceptance Certificate by the purchaser
 - c. 30% payment after successful commissioning of machine at purchaser premises against issuance of FAT certificate by the consignee on successful trial run
-

8.9 Machine Layout

- a. Machine layout giving all detail of installation of the machine, equipment and accessories would be provided by the OEM
-

8.10 Technical Support

- a. The supplier shall confirm that after handing over of the machine there shall be technical support at least for 15 years as & when required by the purchaser. In addition, the purchaser shall be kept informed regarding latest advancement in the related technology for further improvement in the production and operation of the machine.
 - b. Supplier shall confirm the overhauling need of machine after extensive use
-

8.11 Packing

- a. All items should be delivered in sea worthy packing. Provision must be made for handling of the machine by cranes, fork lifters and other equipment.
-

8.12 Environmental Aspects

- a. The machine must meet the requirements of environmental aspects
-

Bid Qualification & Selection Criteria

Sr. No.	Technical/Commercial aspects to be considered to ease out most advantageous bid	Compliance level			Remarks
		Fully Complied	Partially Complied	Not Complied	
1.*	Bid submitted in compliance with PPRA Rule 36(d)				
2.*	Confirm to tender specification				
3.*	Confirm to tender quantity(s)				
4.	Complete technical literature/ Brochure /catalogue provided in first go along with technical bid				
5.	Prices are valid for any reduced quantity(s) without notice				
6.*	180 days bid validity from date of opening of commercial offers/bids confirmed				
7.	Delivery period as per schedule of tender enquiry confirmed				
8.	Payment terms as per tender enquiry				
9.	In case of new entrant, proof of past performance / list of identical supplies to prove capabilities in the relevant field				
10.*	Certificate regarding fulfillment of all tender requirements				
11.*	T.E Undertaking- Signed/Stamped				
12.*	Offer /bid (Tech + Comm) is un-conditional				
13.*	Complete company profile				
14.	Certificate that firm is not blacklisted or under debarment by any Govt/ Semi Govt organization				
15.	Confirmation of Performance Bond against LOI (Letter of Intent) as per T.E Clause				
16.*	Main Features as per Annex "A" of T.E				
17.*	Technical Requirements as per Annex "A" of T.E				
18.*	Site & operating conditions as per annex "A" of T.E				
19.*	Country Of Origin as per Annex "A" of T.E				
20.*	Specification for Electric Supply System as per Annex "A" of T.E				
21.*	Literature Required as per Annex "A" of T.E				
22.*	Additional Equipment as per annex "A" of T.E				
23.*	Terms & Conditions as per Annex "A" of T.E				
Note: Clause with (*) are necessary to be complied. In case of non-compliance of the same, the bid will be disqualified					

Signature of the Tenderer with stamp

Place.....

Dt:

Before Grinding:

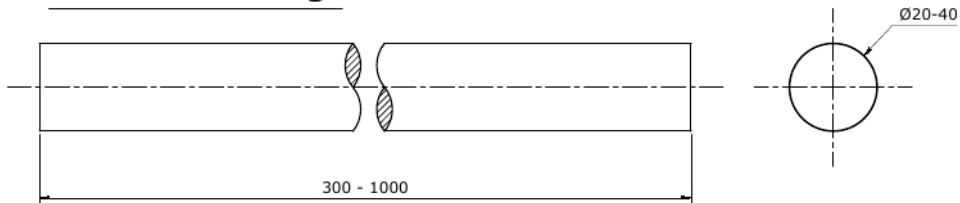

Material = 91 - 93%W, Rest are binders
Hardness = 300 - 500 VHN
Input Surface = Rough machined job, with taper of 0.5mm approx

After Grinding:

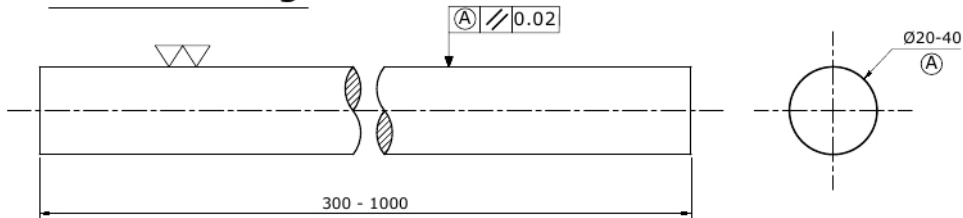

All Dimensions are in mm.
Surface Finish = 1.6 - 6.3µm
Parallelity = 0.02mm
Tolerance on Ø = ±0.003mm

Sketch No. TA/13